



DEE GARDENS

DEESIDE

## THE KNIGHTSBRIDGE

3 bedroom home



Artists impression, features may vary

WELSH ROAD, GARDEN CITY, DEESIDE, CH5 2RA

 **Keepmoat®**

## DEE GARDENS



## THE KNIGHTSBRIDGE

3 bedroom home

### GROUND FLOOR

Kitchen / Dining	3035 x 4499	9'11" x 14'9"
Lounge	4266 x 3551	14'0" x 11'8"
WC	961 x 1510	3'2" x 4'11"

### FIRST FLOOR

Bedroom 1	3390 x 3646	11'1" x 12'0"
En-suite	2472 x 1492	8'1" x 4'11"
Bedroom 2	3211 x 2587	10'6" x 8'6"
Bedroom 3	2240 x 1819	7'4" x 6'0"
Bathroom	1661 x 2587	5'5" x 8'6"

› Longest measurement taken

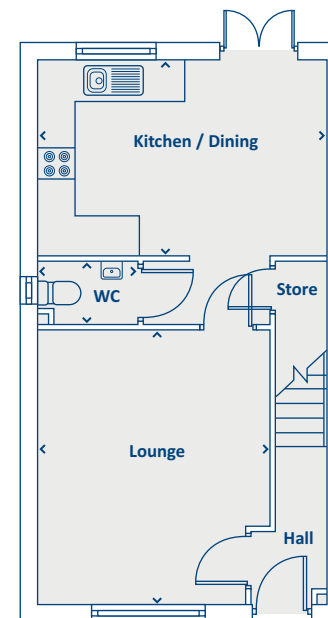

GROUND FLOOR

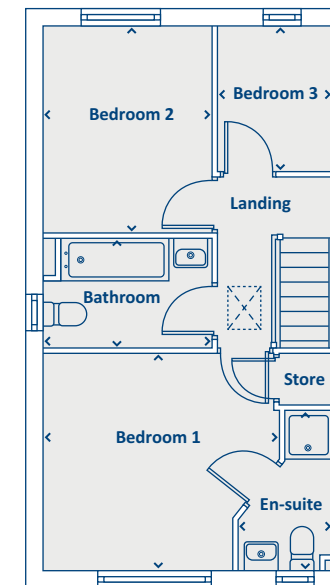

FIRST FLOOR

#### PLEASE NOTE:

For illustration purposes only. All dimensions are + or - 50mm and these measurements should not be used for the purchase of carpets or furniture. Please see our Sales Executive for full specification and plot details at this development.

Keepmoat is the trading name of Keepmoat Homes Limited

